

# PUNCH ASSEMBLY

UP-20  
UP-40



# PUNCH ASSEMBLY

## UP SERIES TECHNICAL SPECIFICATION

Solid Models & Video Available Online

Our modular punch assemblies have a punch-and-die design to make custom-shaped cut-outs. Available in pneumatic or electric configurations, our punch units use hardened-steel tooling that is clean-cutting and fast-acting. The assembly can be mounted in any orientation, so you can add it to any converting, processing, or assembly line in any way you see fit!

Just bolt it on!

### UP-20

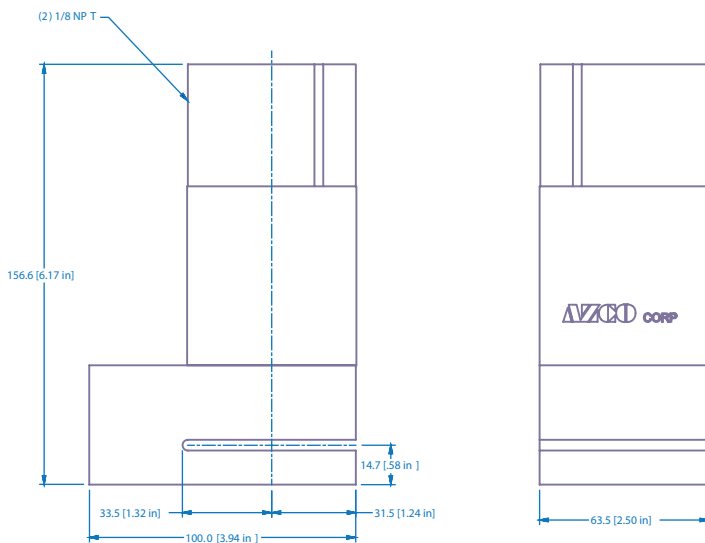

### UP-40

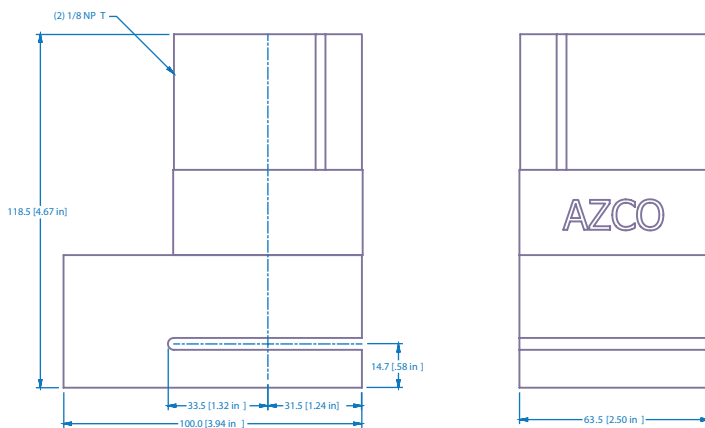

### BENEFITS

- Clean cutting
- Fast acting
- Easily moved
- Can be mounted in any orientation

### MATERIALS

- Film
- Foil
- Hose
- Non-woven
- Paper
- PTFE
- Tubing
- Shrink Tubing
- Metalized Film
- Tape
- Foam
- Rubber
- Thin-gauge Metal
- Mesh
- Laminates
- Medical Devices

### SPECIFICATIONS

- Modular design and construction
- Custom sizes and configurations
- Pneumatically operated punch
- Hardened and precision ground matched punch and matrix
- Framework is supplied in clear anodized aluminum
- Punch and matrix will be a matched set
- Any design that fits within a 40 mm/1.6" diameter circle
- Centerline of punch is 38 mm/1.3" from edge of web and can be modified to meet your requirements
- NPT Fitting
- 90 PSI (6 bar) compressed air

### OPTIONS

- Custom shapes
- Extra depth throat
- Material guides
- Sensors



### WARNING:

EQUIPMENT MUST BE GUARDED IN ACCORDANCE WITH ALL FEDERAL, STATE, AND LOCAL REQUIREMENTS



visit us online!



FOR ALL YOUR FEEDING AND CUTTING NEEDS

26 Just Road, Fairfield, NJ, 07004 | 973-439-1428 | [azcocorp.com](http://azcocorp.com)